

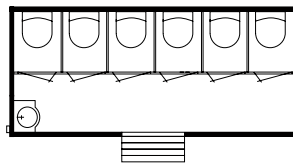

- afm. 500 (l) x 220 (b) x 300 (h)
- ingang d.m.v. stalen trapje
- electra: 230 V 16 Amp.
- wateraansluiting: 3/4"
- afvoer: Ø 110 mm
- **170 H-luxe:** 1 toiletten, 6 urinoirs. 1 wastafel incl. handdroger en zeepdispenser
- **170 D-luxe:** 6 toiletten. 1 wastafel incl. handdroger en zeepdispenser
- optioneel: kachel, septic tank, tent aansluiting
- dimensions 500 (l) x 220 (w) x 300 (h)
- entrance by steel steps
- electricity: 230 V 16 Amp.
- waterconnection: 3/4"
- sewage: Ø 110 mm
- **170 H-luxe:** 1 Male toilet, 6 urinals, 1 handwashbasin incl. handdryer and soapdispenser
- **170 D-luxe:** 6 Female toilets, 1 handwashbasin incl. handdryer and soapdispenser
- optional: heater, septic tank, tent connection material

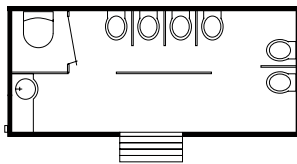

170-luxe H

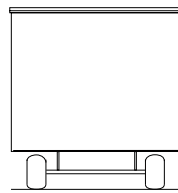
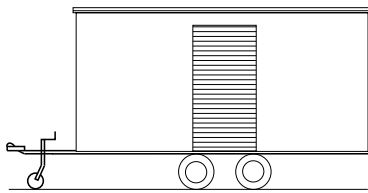

170-luxe D

